

County Surveyor's Record, Tillamook County, Oregon

CHAINS

ESTABLISHED CORNERS FOR OREGON STATE BOARD OF FORESTRY

East One Sixteenth corner common to Sections 6 & 7,
T. 2N, R. 9W, W.M., Tillamook County, Oregon.

ESTABLISHED

Var. 21 1/2 E

Set 1 1/2" x 36" galvanized iron pipe with 3" bronze cap marked "OREGON STATE BOARD OF FORESTRY E 1/16 S6 S7 1958 RS401," 32 inches in ground, and from which a:

- 9" Hemlock bears S23E 18.5 ft.; scribed E 1/16 S7 BT.
- 20" Hemlock bears N70E 55.8 ft.; scribed E 1/16 S6 BT RS401.

Oregon State Board of Forestry metal location poster on 4" Hemlock S45E 7.6 Ft.
Set 4" x 4" x 60" white painted Cedar post 1.8 Ft. SW. of pipe.

Center East One Sixteenth corner for Section 6,
T. 2N, R. 9W, W.M., Tillamook County, Oregon.

ESTABLISHED

Var. 21 1/2 E

Set 1 1/2" x 36" galvanized iron pipe with 3" bronze cap marked "OREGON STATE BOARD OF FORESTRY E 1/16 C--C S6 1958 RS401," 35 inches in ground, and from which a:

- 9" Hemlock bears N52E 22.0 ft.; scribed CE 1/16 S6 BT RS401.
- 6" Hemlock bears S51E 4.0 ft.; scribed CE 1/16 S6 BT.

Oregon State Board of Forestry metal location poster on 6" Hemlock BT.
Set 4" x 4" x 60" white painted Cedar post 1.5 Ft. N.W. of pipe.

Dated February 19, 1958

Established by

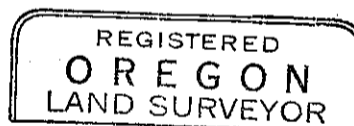

Richard A. Morris

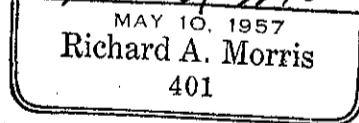

Present and witnessed by Robert Sturm
Harold Russell

Book I